

**A guide to  
install a new  
ENHET kitchen**

# **ENHET kitchen installation guide**

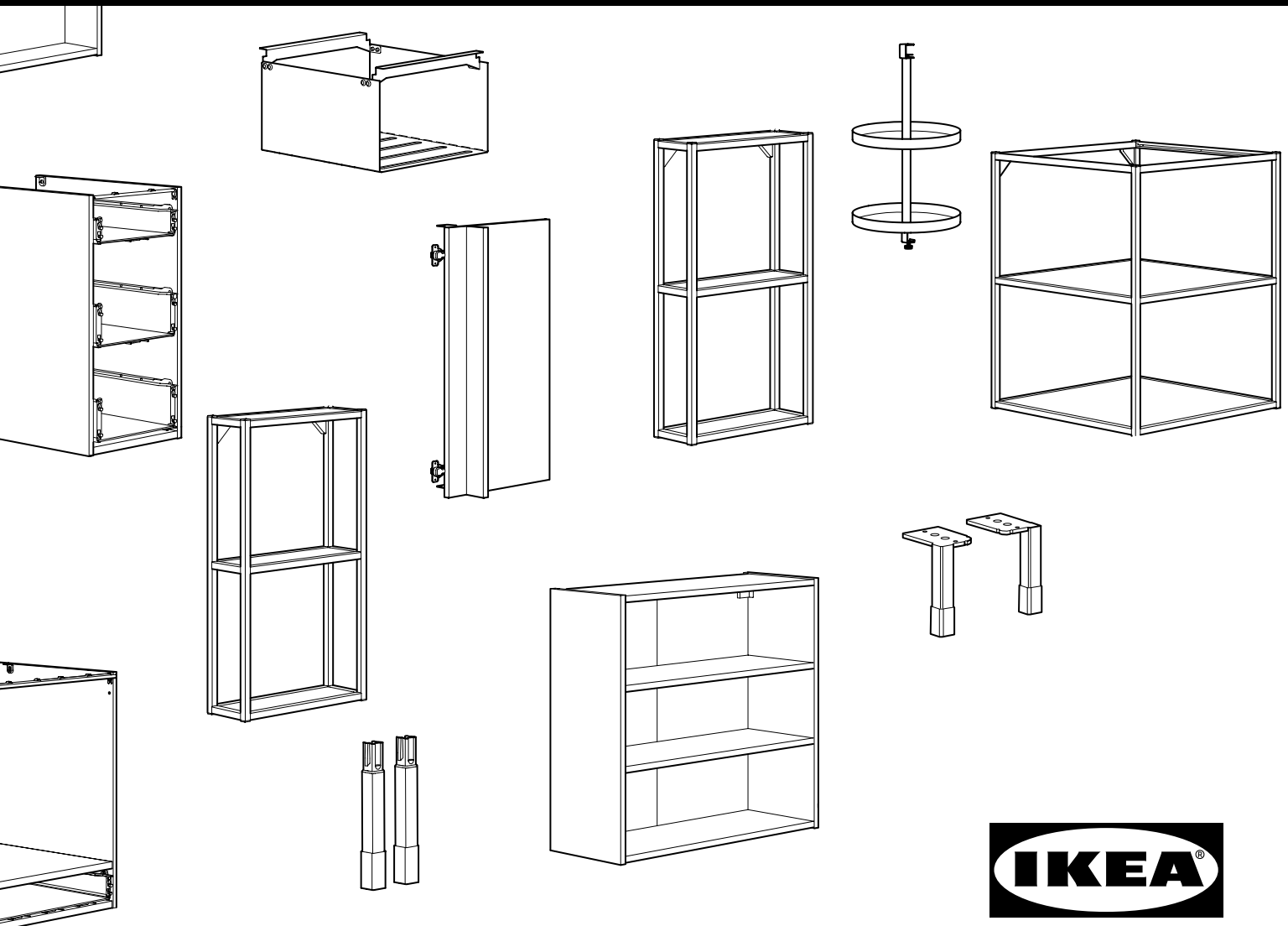

# The step-by-step guide

## Installing your new ENHET kitchen correctly

This brochure is your guide to preparing and installing your new kitchen yourself. Inside you'll find clear steps to follow as well as useful tips and ideas. Use this guide along with your IKEA assembly instructions to make sure your kitchen is installed in the right way.

## Before you begin

Go through this brochure before you begin to see what stages are involved in putting in your new kitchen and to organise what tools you'll need. To make sure you have everything for your new kitchen, compare the packages and parts you have at home against the order list and the freight list. You should only dismantle your old kitchen when you have all your new parts and appliances. Your kitchen parts and worktop should be stored indoors, with normal room temperature and humidity.

Before you remove your old kitchen you need to make sure that your electricity, gas and water is shut off. Use a qualified professional to disconnect and connect your gas, water and electricity.

## You can do it yourself but you don't have to

Although our kitchens are designed to be as simple as possible for you to assemble and install yourself, it is important to consider all aspects of a kitchen renovation, where some key operations, such as safeguarding a proper wall cabinet installation or cutting your worktop, require more skill and experience than others.

We can offer you services ranging from planning and delivery to complete kitchen installations. For more details see the back page of this guide, kitchen section of IKEA.gr or contact your local IKEA store.

# Table of contents

The tools you'll need.....	03
Preparing your room.....	04
Assembling the cabinets and frames.....	06
Installing the wall cabinets/frames.....	07
Installing the base cabinets/frames.....	08
Installing the worktop.....	09
Installing the sink and tap.....	10
Installing the appliances.....	11
Installing the plinth.....	12
Installing lighting, doors and drawers, fronts and handles.....	13
Building a kitchen island.....	14
You're done! Congratulations on your new kitchen!.....	15
Services.....	16

# Tools and materials

Here is a summary of the basic tools you'll need. In addition you'll find what tools to use for each product in their respective assembly instructions.

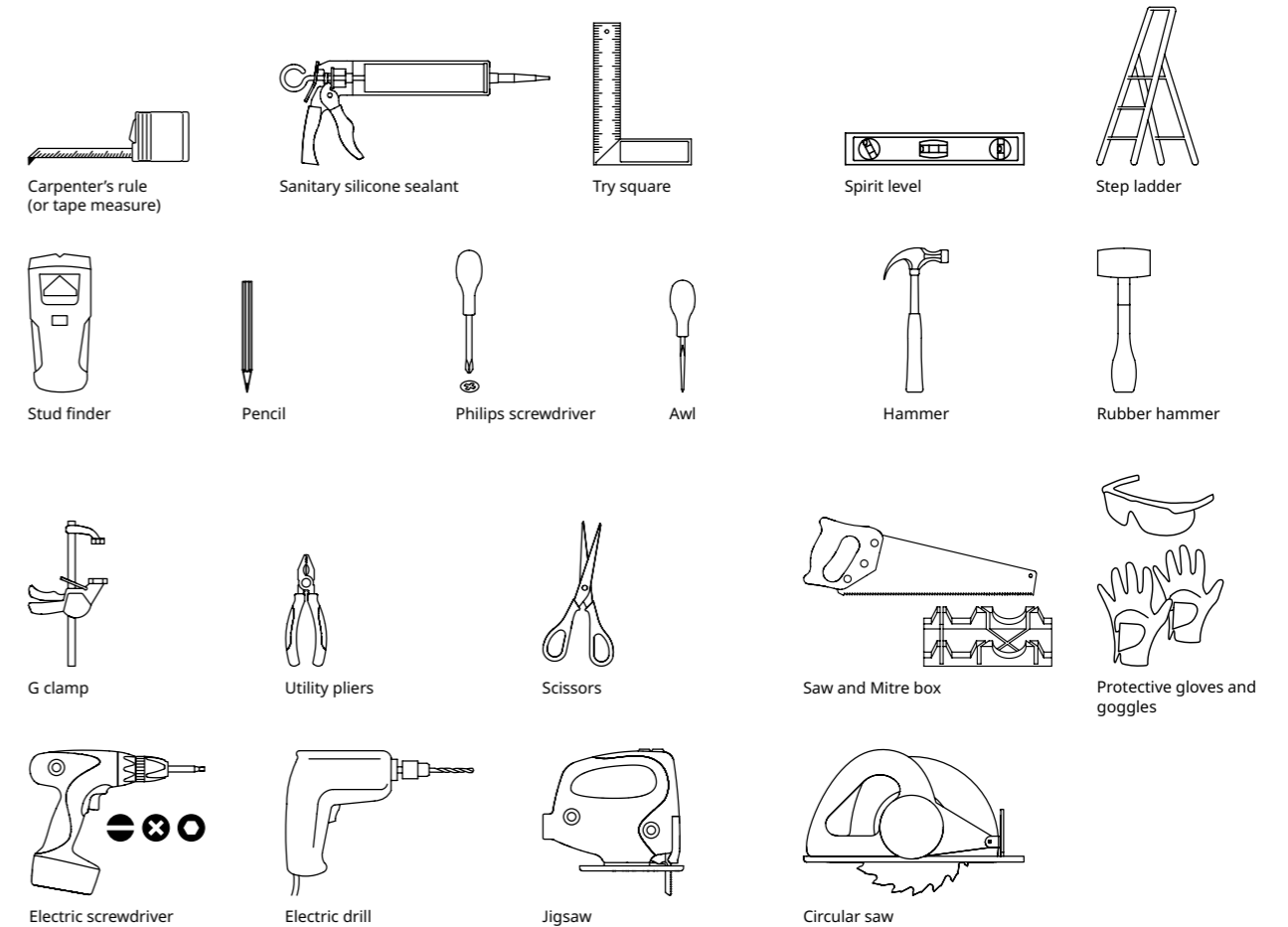

## Materials

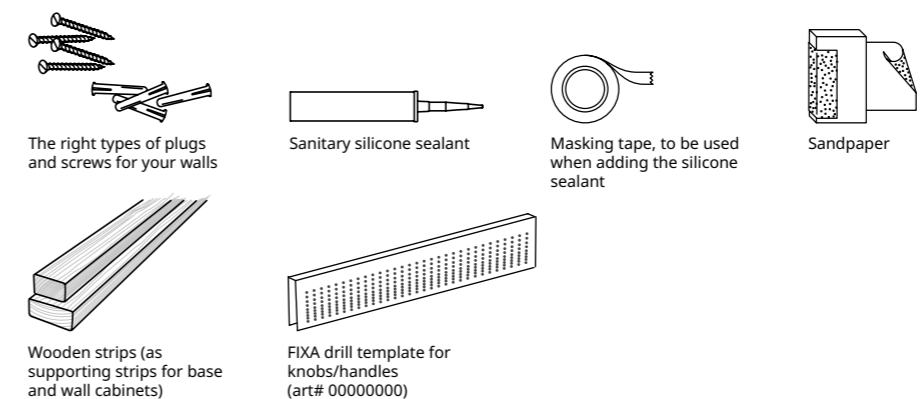

# Preparing your room

Whether you're replacing an old kitchen or starting from scratch, it's key to understand that the properties of the room dictate how complex or smooth your installation process will be. With this in mind it's important that you spend sufficient time assessing walls and floors before you start the installation. Now is also the time to prime and paint your walls and change your flooring. Don't apply the final coating of paint at this point since you will need to make markings and drill holes in the walls. If you plan to have tiles or similar, it's best to install these after the cabinets and worktop have been installed.

## Assess your walls

Since your walls will hold the weight of your kitchen cabinets and frames, start by evaluating the quality and construction of your walls.

## Marking cabinet positions

Draw a layout of your new kitchen directly on the wall. Check that everything fits with the measurements from your plan and that your electricity, water, gas and ventilation connections are where you want them to be.

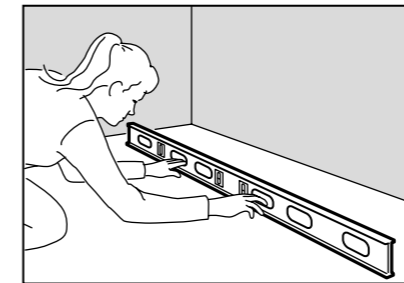

Use a spirit level to find the highest point of the floor and mark where that is on the wall. This will be the reference point from which to measure when marking the key measurements (see below).

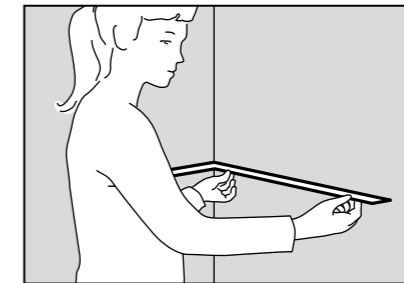

Prepare your space by making sure your corners are even and your walls and floor are straight. Use your try square for the corners and a spirit level for the walls and floor.

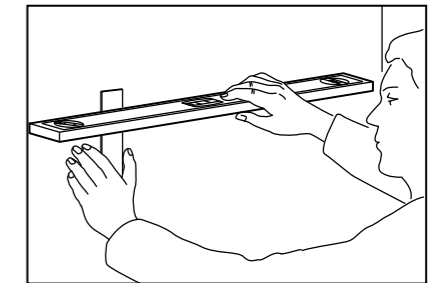

If your corner and/or walls aren't straight you may need to use distances to make sure your kitchen cabinets and frames become level and align properly. For advice contact your local specialised dealer.

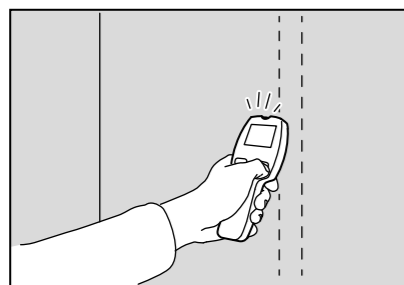

Check that your walls are strong enough to hold the cabinets. Depending on your wall material, it's best to install your cabinet onto a stud or support beam. Use a stud finder to locate the studs.

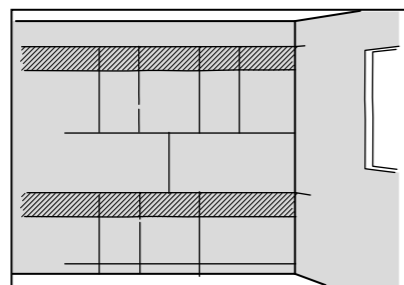

What you are looking for is a fixed structure inside the wall that is strong enough to carry the load of your cabinets. Keep in mind that this fixed structure needs to align with the fixation points of your cabinets.

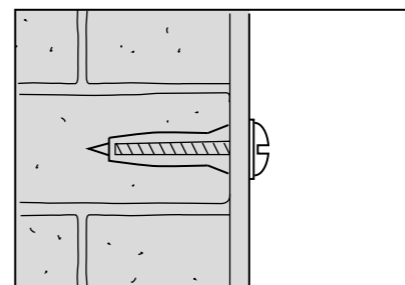

Find out what type of wall you'll be working with. For solid core materials like masonry that are hard to penetrate and can support great loads, you need special anchors and screws.

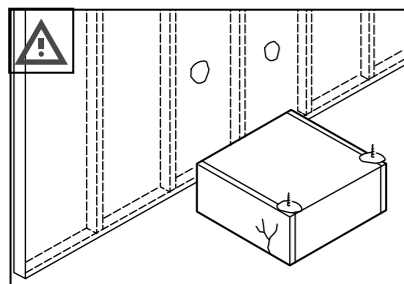

If you have a light wall construction with gypsum (drywall) wall panels supported by studs, it's not enough to fix your cabinets onto the thin gypsum board alone (not even using drywall anchors).

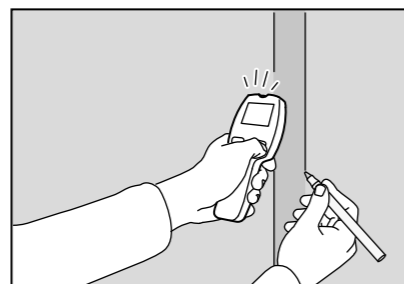

Instead, you need to locate the studs inside the wall using a stud finder. Studs are mostly vertical posts made of wood, but can also be thin metal profiles, and run from the floor all the way to the ceiling.

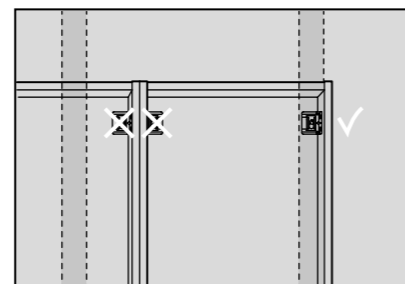

The wall studs, normally located 30, 45 or even 60 cm apart, can carry the load of your wall cabinets. However, as the cabinets come in different widths it is highly likely that the fixation points of the cabinets and position of the studs won't align.

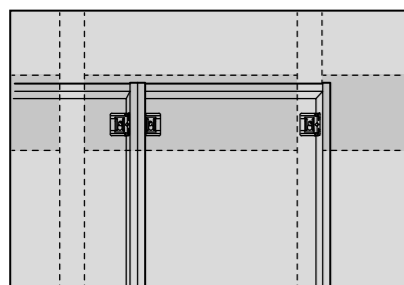

In order to provide proper support for the cabinets, you need to add horizontal structural support between the studs. As this requires the proper skills, be sure to contact a professional for help.

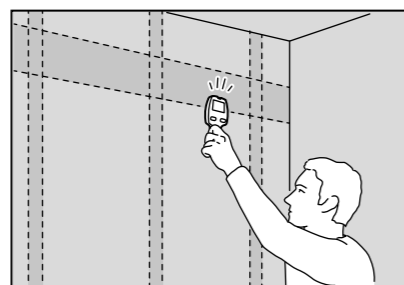

Note that even if your new cabinets will be located at the same position as the cabinets of the old kitchen, it is important to secure that the walls have been properly reinforced.

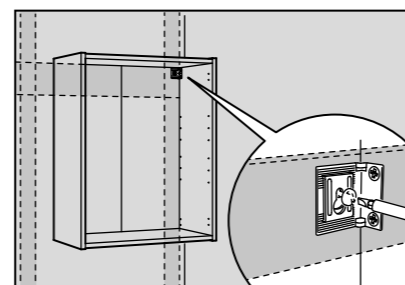

It's important that you use the proper type and size of fixing devices to attach your cabinets. The minimum screw thickness is 4.6 mm and the screw needs to penetrate at least 38 mm into the wall stud or solid core material. For advice, contact your local specialised dealer.

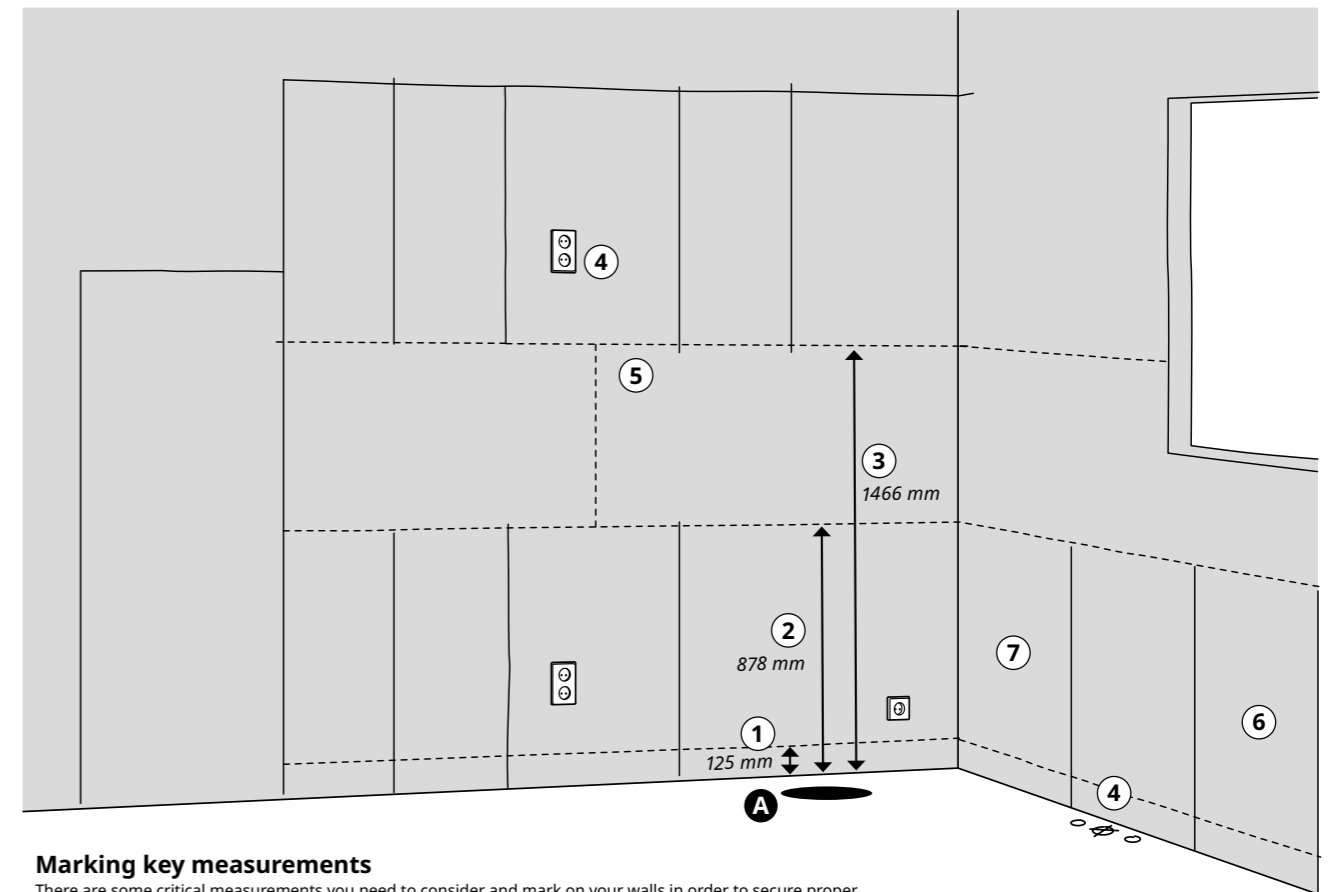

## Marking key measurements

There are some critical measurements you need to consider and mark on your walls in order to secure proper alignment, leave adequate room for your work area and follow appliances requirements. Remember to consider the space needed for doors and drawers to open properly, making sure there are no collisions with for instance radiators or window sills as drawers and doors are opened.

1. First mark 125 mm from the highest point (A) you found at the very beginning and trace a horizontal level line across your wall where the cabinets will be placed. This base line represents the height of the cabinet legs.
2. Second mark 878 mm from the floor and proceed as before. This is where the top of your base cabinets will end up.
3. Finally, mark another line at 1466 mm from the floor and trace a horizontal line as with the other markings. This line represents the bottom position of the wall cabinets and frames.
4. With the lines marked, double-check that your plumbing and electrical outlets fit with your layout plan.
5. Pay attention to the required minimum distance between hob and hood. This can be found in the extractor hood assembly instruction.
6. The dishwasher should only be installed between two cabinets or at least between a cabinet and the wall. This in order to secure the appliance properly and provide support for the worktop.
7. If you have a kitchen with a corner, you build the corner base solution with a regular 80 cm base cabinet and an ENHET corner panel. For the positioning of this solution, see page XX.

# Preparing your room

Start by installing the supporting strips. You can use any straight long piece of wood available at your local hardware store.

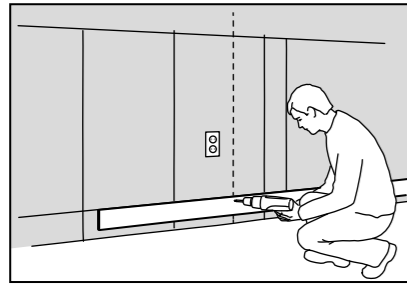

To install the supporting base strip, align the top of the strip with the baseline (125 mm). Screw the strip to the studs you found behind your walls along where your base cabinets will be located. Make sure the strip does not go beyond where the last cabinet ends or it will collide with your plinth at the end.

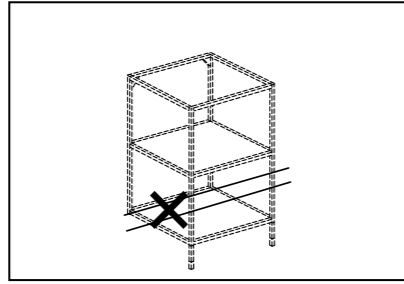

**Note:** Don't install a supporting base strip behind ENHET open base frames, nor the dishwasher.

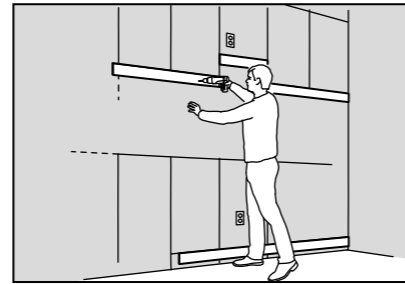

For the upper strips, align the top of the strip with the 1466mm line. Then, screw the strips to the studs you've located behind your wall. The upper strips are only temporary and will be removed once you've installed the cabinets.

# Assembling the cabinets and frames

Before you start assembling the cabinets, try to set up a good work area that is safe and where you have enough room. Be sure to protect the floors and make sure you have the recommended equipment/tools close-by.

Sort the packages into groups to avoid confusion over which pieces belong to the cabinet assembly and which belong to appliances, for example.

For a good workflow, it is a good idea if you assemble all frames one by one and push them aside until the time comes to install them.

It's helpful if you arrange your cabinets in the order you will be installing them. Use your packing list and IKEA home planner drawing to help you.

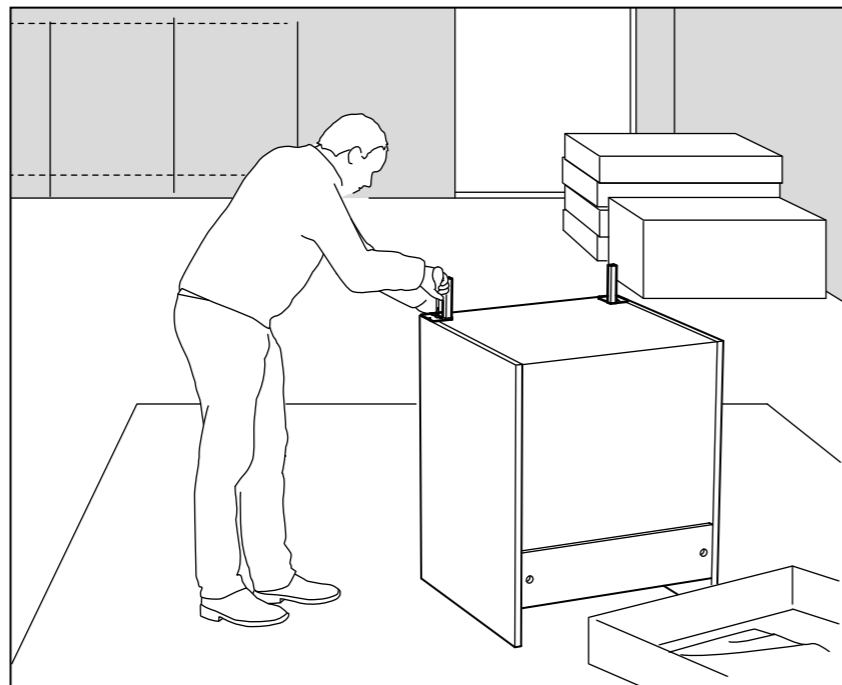

ENHET cabinets can be installed with or without a plinth, depending on your personal preference. See page 12 for info on how to assemble the legs if you choose to have a plinth.

# Installing the wall cabinets/frames

In most kitchens it's best to install your wall cabinets and frames first. This way you have room to move without base cabinets in the way.



**Reminder** Fastening/fixing devices for the wall (i.e. screws and plugs) are not included with the cabinets and frames since different wall materials require different types of fastening devices. Use fastening devices suitable for the walls in your home. For advice on suitable fastening devices, contact your local specialised dealer.

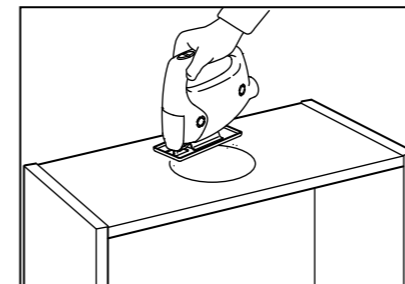

If you have an extractor hood placed under a cabinet, you need to make some cut-outs in the cabinet before you place it on the wall. Follow the assembly instruction of the extractor hood to prepare the required cut-outs. After you've made the required cut-outs, remember to seal the open edges with silicone.

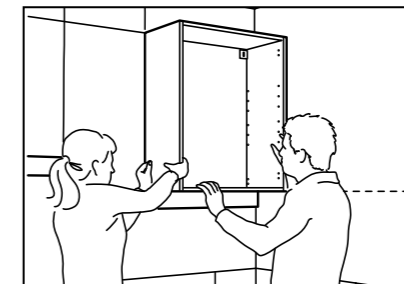

Start from the corner of your room. Place the cabinet on top of the supporting strip and slide it into position.

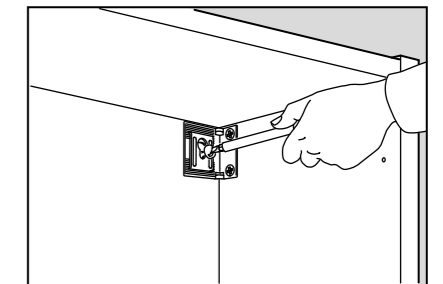

Fix the cabinet using the appropriate length and type of screw. (Throughout the installation process you may need to loosen the screws a bit in order to make smaller adjustments when aligning the cabinets and frames.)

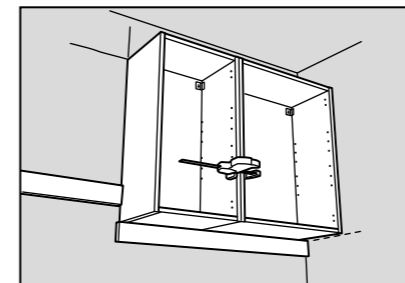

Proceed with the next cabinet, using a clamp to align the two cabinets before you screw them together with the screws enclosed with the cabinet.

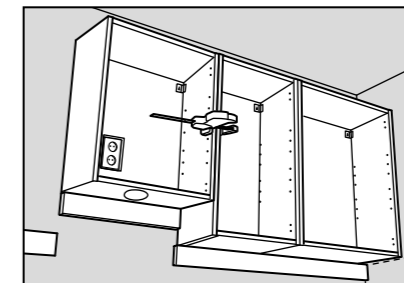

As you place the cabinet adjusted for the extractor hood, make sure you can access the electrical outlet via the previously made cut-out.

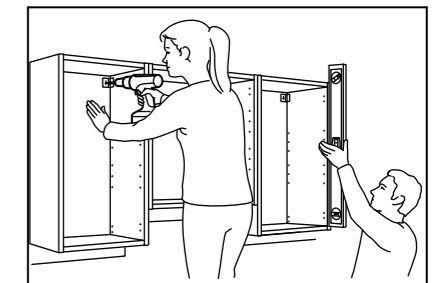

When you have placed and aligned all cabinets and open frames, it is time to secure them in their final location. Before you tighten all screws a final time, use the level to check that all angles are straight.

# Installing the base cabinets/frames

Once you are done with the installation of the wall cabinets you move on to the base cabinets. Again, start from the corner of the room and place the cabinet on the supporting wooden strip. If you build a line kitchen, make sure you leave some space between the wall and the cabinet to allow for doors or drawers to open properly.

If you have a corner kitchen, you build the corner base solution with a 80 cm base cabinet in combination with the ENHET corner panel. For this solution, follow the assembly instruction included with the ENHET corner panel.

**Note:** ENHET open frames can't be used under a sink, built-in hob or for a built-in oven.

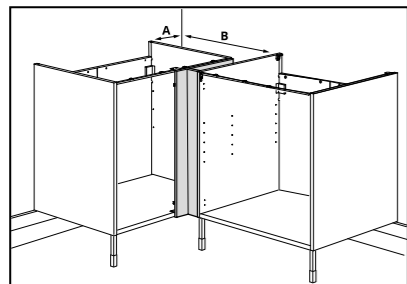

If you build a corner base solution with a 40 cm door, place the cabinet 268 mm from the wall (A). If you build it with a 60 cm door, place the cabinet 468 mm from the wall (A). In both cases, the adjacent cabinet is placed 688 mm from the wall (B).

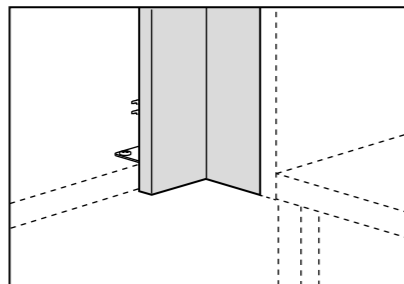

Make sure that the corner panel and the front edge of the adjacent cabinet align.

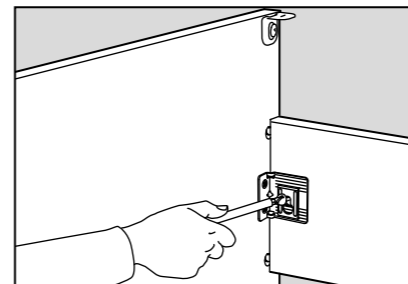

Fix the cabinet using the appropriate type and length of screw. (Throughout the installation process you may need to loosen the screws a bit in order to make smaller adjustments when aligning the cabinets and frames.)

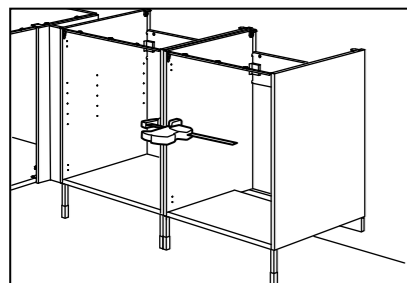

As you proceed with the next cabinet, level and align the two cabinets by using a clamp. Use the screws provided to attach the adjacent cabinets.

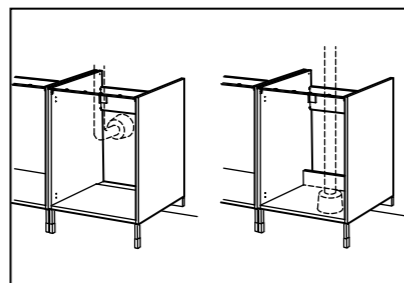

When you reach the place where you want your sink and tap, use the designated ENHET cabinet for sink, which has a construction that allows for pipes coming from either the wall or the floor. See assembly instructions for how to build the different configurations.

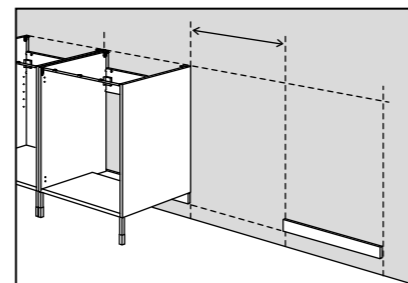

The dishwasher, normally placed next to the sink cabinet, stands on its own base so here there is no need for a supporting strip. Leave a 60 cm wide gap between the sink cabinet and the next cabinet.

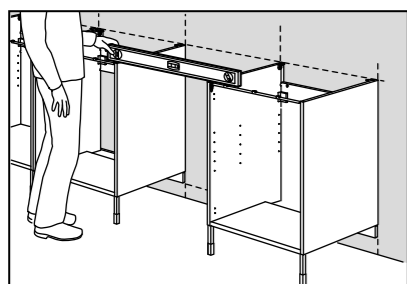

To install a cabinet after the dishwasher niche, make sure the spirit level reaches both cabinets at the front and at the back of the cabinets. Make sure the distance at the front and back of the niche remains 60 cm. Once you have the correct alignment, secure the cabinet to the wall.

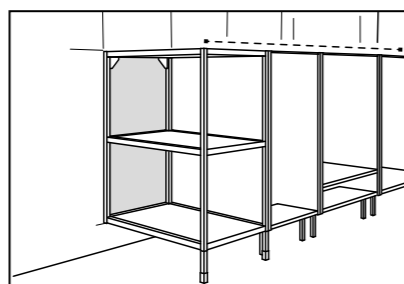

When you install an open base frame, you don't use a supporting strip. Instead, align the top of the open frame with the top of the adjacent cabinet before you fix the frame to the wall.

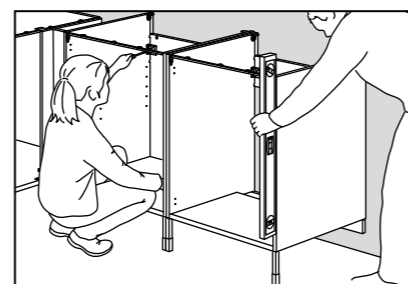

Once all your base cabinets are installed, check that they are level and that you are happy with the result, before securing them by tightening the screws a final time.

# Installing the worktop

With your cabinets in place, it's time to install your worktop. Before you start, be sure to read the worktop assembly instruction to learn about the things you need to consider as you prepare and install it. When cutting the worktop to fit it with your kitchen, keep in mind that you are you are handling rather thick and heavy material so make sure you have the proper work

space and tools. It's helpful to use a pair of sawhorses to setup a cutting station. Here, you can benefit from having a second person available, to help you carry and hold the worktop while you perform the different steps. If you need to customise your worktop for a sink or hob, follow the assembly instruction of your sink or hob.

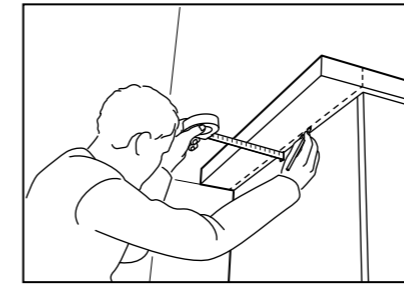

Start by placing the worktop on top of the base cabinets and push it against the wall. Once in position, measure the worktop from the side edge of the cabinet underneath. With the addition of at least a 1.5 cm overhang, make a mark on the worktop.

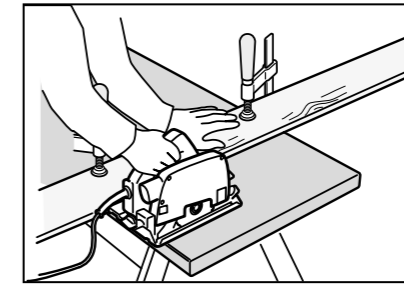

Use a circular saw and G clamps to keep a straight line as you cut the worktop. To avoid splinter, cut with the worktop underside facing up when using a buzz or jig saw, but with the top facing up if using a handsaw. A tip is to have a second person hold the piece to be cut off to avoid the edge from splintering.

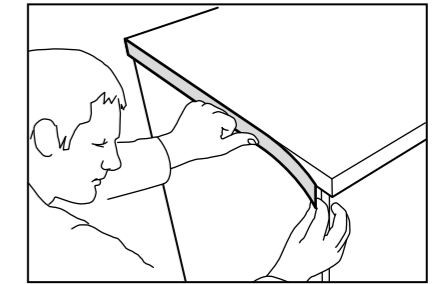

After you have cut the worktop you need to seal the cut raw edge. Open edges create an entry point for humidity or water, which could cause swelling and deterioration. Follow the assembly instruction of the worktop to apply the edge band that comes with each IKEA pre-cut worktop. If you do not have a lose strip we recommend to seal the open edge using silicone.

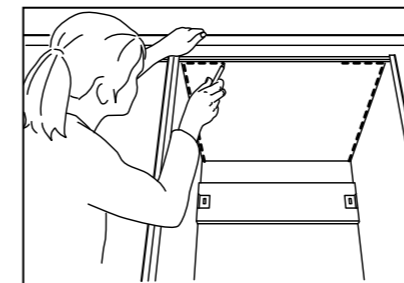

**For a sink cut-out,** you start by tracing the inner boundaries of the sink cabinet on the underside of the positioned worktop.

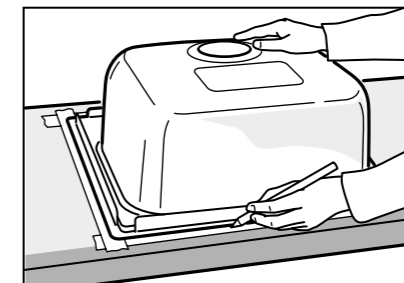

Place the worktop upside down, then place the sink upside down within the previously marked boundaries/lines, making sure there is equal space all around. Trace the outline of the sink.

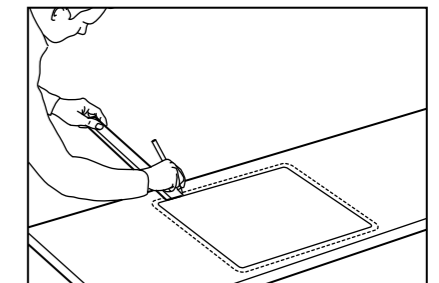

Then, follow the assembly instruction of the sink to mark the actual cutting line.

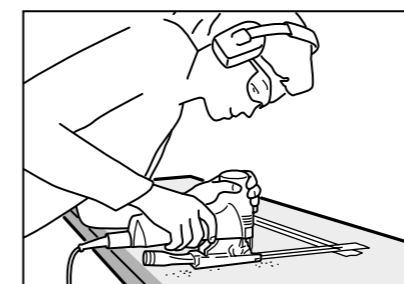

Use a jigsaw to cut out the space for your sink. It's helpful to drill a hole in the inside corners of your outline before cutting. These holes, big enough to fit the jigsaw blade, serve as the entry point for the jigsaw and enables you to make a cleaner cut.

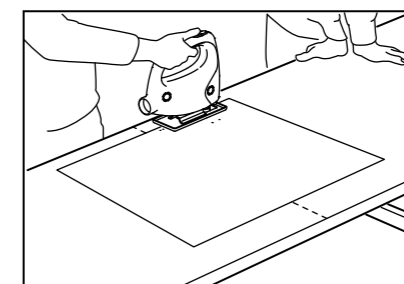

**For the hob cut-out,** locate the mid point of the hob cabinet. See the hob installation guide for the cut-out dimensions and the minimum distances to pay attention to. Make sure that the cut-out perimeter doesn't collide with the top rail of the cabinet.

For last steps on installing the worktop, see next page →

# Installing the worktop

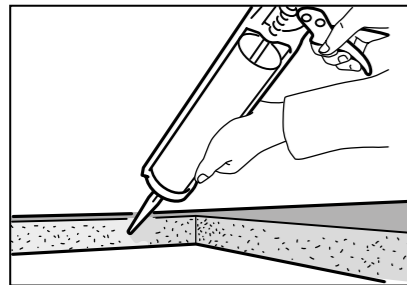

Clean the raw edges of the cut-out(s) and sand them a little bit. Then apply silicone to prevent moisture from penetrating the worktop. Let the silicone dry before you install the sink and/or hob.

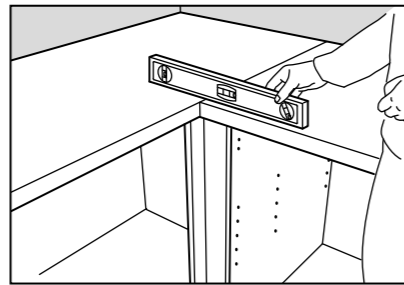

Corners can be tricky so take your time and adjust both pieces until they are perfectly aligned and level. For small adjustments, use the adjustable feet, or if necessary, shim between the cabinet and the worktop.

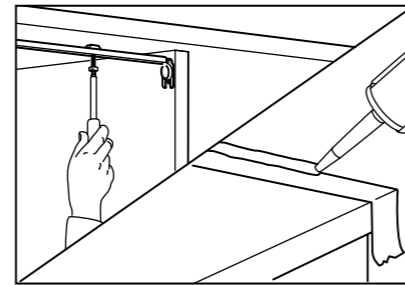

Once the worktop pieces are level and align with the wall, fix the worktop to the cabinets and apply silicone in order to prevent fluids from penetrating the worktop.

# Installing the sink and tap

Before you start to install the kitchen mixer tap, double-check that the connections between the water supply and the tap fit. Then switch off the main shut-off valve. Keep in mind that the installation must be performed in compliance with current local construction and plumbing regulations. If in doubt, contact a professional.

While some of our sinks come with a pre-cut hole for the tap, there are cases where you need to install the tap on the worktop. If this is the case, make sure you use a drill that is powerful enough to drill through the worktop material.

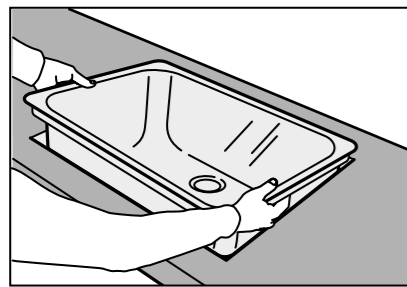

Before sliding the sink into position, follow the assembly instruction of the sink and attach the clamps that comes with it. Once in position, adjust the clamps in order to fixate the sink.

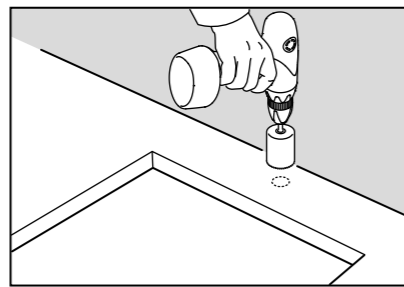

If you need to install the tap on the worktop, see the assembly instruction of the tap for the dimension of the hole. Once you've marked the position of the hole, check that it doesn't collide with the top rail of the cabinet underneath. After you've drilled the hole, clean and seal the hole with silicone.

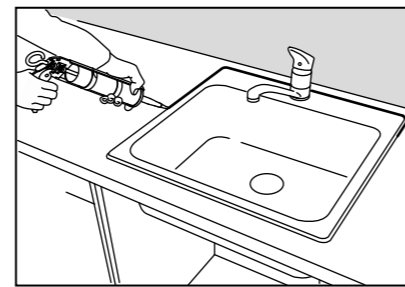

Once the sink and tap are in place and secured, seal the edges around them with silicone to secure a water tight seal.

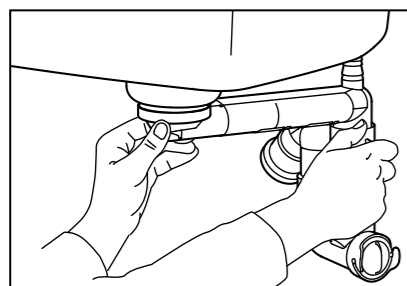

Next, follow the assembly instructions of the water trap and tap to finalize the sink and tap installation.

# Installing the appliances

When all worktop sections are secured and you've given the silicone time to seal all raw edges of the cut-outs, it's time to start installing your appliances. Throughout, be sure to follow the assembly instructions and specifications that come with the appliances. **Note:** All water, gas and electricity connections must be done by qualified professionals according to valid local safety regulations.

The extractor hoods at IKEA can be installed in two ways: either in extraction mode (i.e. ducted to the outside) or used in recirculation mode fitted with a charcoal filter. Each installation option and required cabinet preparation is described in the assembly instruction of your extractor hood.

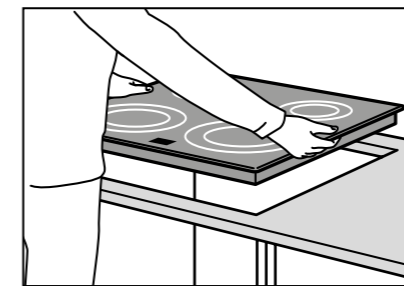

To install the hob, follow the assembly instruction that comes with the hob. Attach the hob connectors before you press the hob into the cut-out.

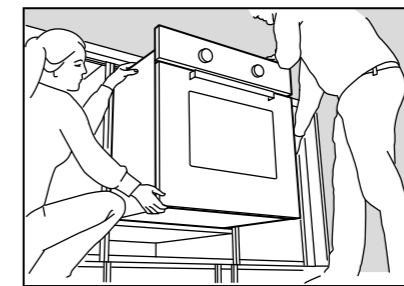

The oven cabinet has been prepared to hold the built-in oven on top of the shelf. Keep in mind that it requires two persons to carry and properly slide the oven into position. Once in position, remember to secure the oven, using the screws provided with the oven.

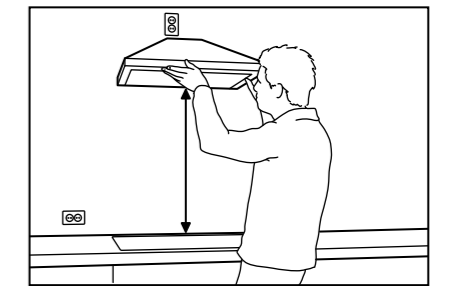

Before you install your extractor hood, make sure you follow the specified minimum distance between hob and extractor hood that is listed in the assembly instruction. Again, we recommend that you find help from someone who can help you hold and fixate the hood while you make the required preparations.

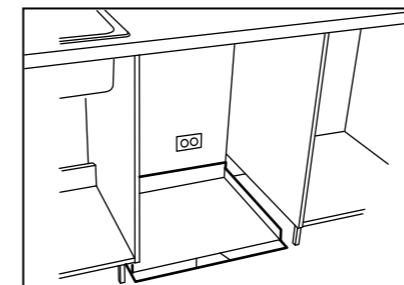

As you prepare for the dishwasher installation, keep in mind that some countries require some sort of floor protection underneath the dishwasher. Required or not, it is a good idea to place a floor protection which holds some amount of water if the water connections of the dishwasher should break.

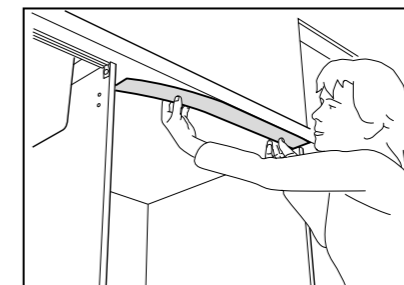

In order to protect the bottom side and edges of the worktop from the steam released when opening the dishwasher after a finished washing cycle, attach a diffusion barrier along the front edge of the worktop.

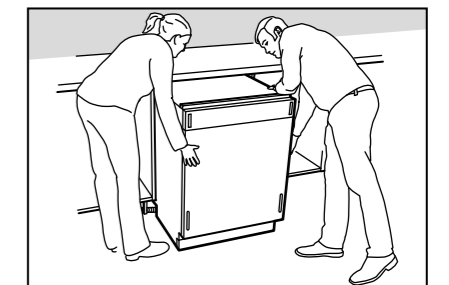

After the dishwasher has been connected to water and electricity, follow the dishwasher installation guide to adjust the height of the dishwasher.

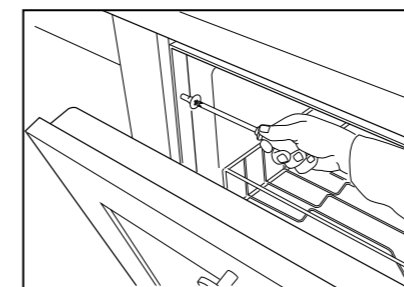

Once the door is mounted, and the dishwasher is level with the adjacent cabinets, you need to secure the dishwasher by following the instructions in the dishwasher installation guide.

**Note:** If you have a fully integrated dishwasher we recommend that you wait to assemble the front onto to the dishwasher until you mount the other kitchen fronts. This makes it easier to align them.

# Installing the plinth

Generally, the base cabinets are supported by the supporting strip along the wall and two legs in the front of the cabinet. However, if you are going for a kitchen with a plinth you also need to consider the following steps:

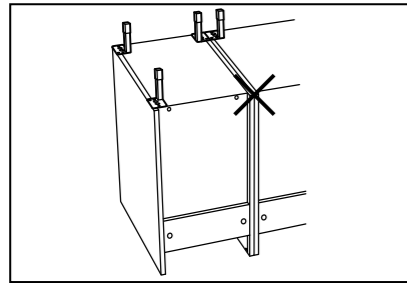

For a plinth setup place the legs with the leg-plate aligned to the cabinet edge. Since the plinth is attached via the legs, you also need an additional leg at the back of the open cabinet sides.

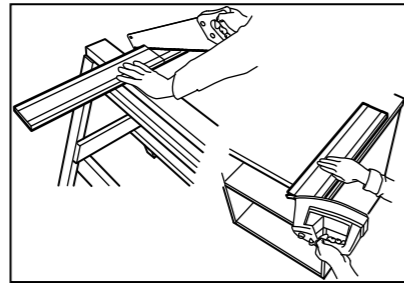

Start with the plinth for the short side of the cabinet and use a handsaw to cut a 552 mm piece. Then, sand the open edge before you apply the pre-glued edge band that comes with the plinth.

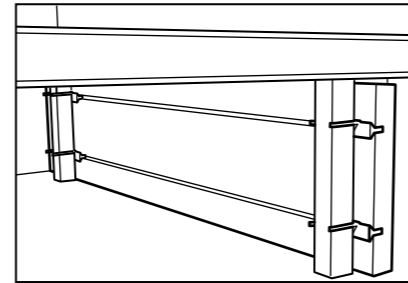

Follow the plinth assembly instruction to attach the plinth. Remember to remove the plastic sleeves of the leg since they will obstruct the attachment of the plinth.

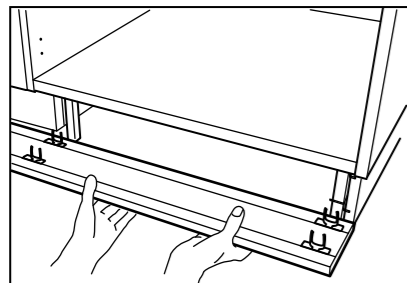

For the front plinth, place the plinth in position and mark where you should cut it. After you've cut it, repeat the process of attaching the edge band and the plastic fittings that connect with the leg.

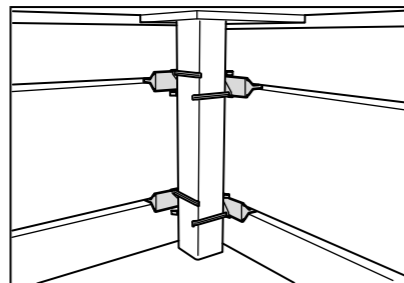

When two plinth sections meet, forming a corner, you need to attach both plinth strips to the same leg. In order to avoid the clips colliding, place the clips upside down in one of the strips.

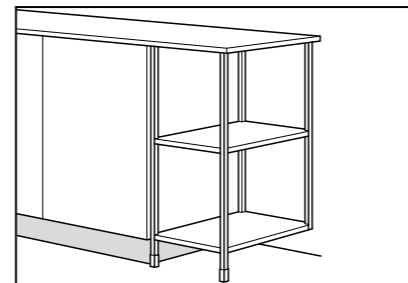

**Note:** ENHET open frames can't be combined with a plinth. For ENHET frames, use ENHET legs for frame.

# Installing lighting, doors and drawers, fronts and handles

With your cabinets, worktops and appliances in place, it's time to move onto installing your lighting as well as fitting the cabinet interiors.

Then, take your time assembling doors, fronts, knobs and handles to make sure everything looks the way you want.

**Note:** Always use your assembly instructions for help.

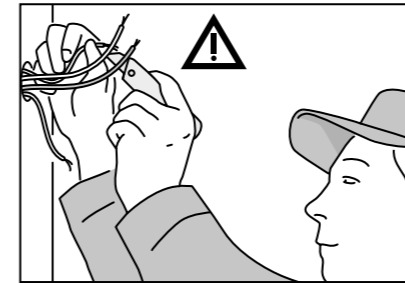

When installing your lighting, keep in mind that all electrical connections must be made by a qualified person.

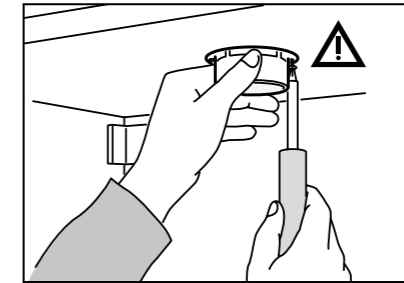

If drilling holes, use a piece of wood to meet the drill as it penetrates the surface to avoid the edges from splintering.

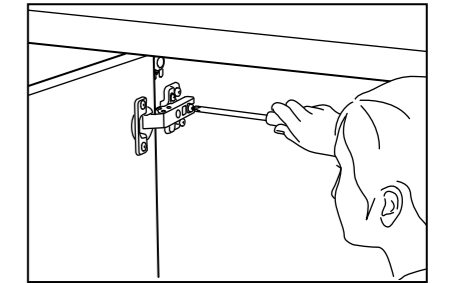

Next, follow the assembly instructions to mount the doors and install the drawers. Once the doors and drawers are in position, you can adjust any potential misalignment by adjusting the hinges and drawers.

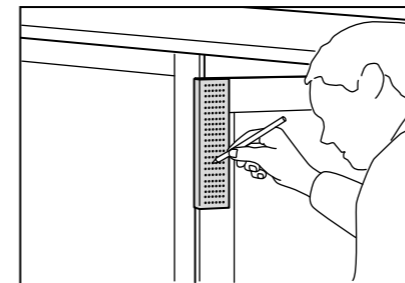

Once you have decided on the placement of your knobs and/or handles, we recommend that you use the FIXA drilling template when assembling the knobs and/or handles, for an easier process and a better end result.

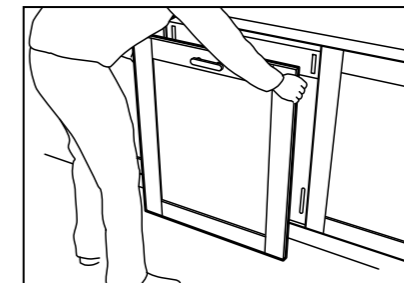

If you have a fully integrated dishwasher you mount a 60x70 cm kitchen door on the front of the dishwasher. In these cases, the assembly instruction and required fittings come with the dishwasher. Keep in mind that the front should be mounted after the dishwasher has been slid into position. This to prevent the dishwasher from tipping over when you open it.

# Building a kitchen island

When it comes to building a kitchen island, it is important to consider some key aspects during the planning and installation. Since the kitchen island will not be supported by the walls, the frames need to be attached to the floor to prevent the island from tipping or moving around. For ENHET, you can build a kitchen island using the open frames along with the assembly kit for kitchen island.



Before fixing the island to the floor, assess your floor and make sure the fixation points of the island do not conflict with floor heating, or electrical lines hiding underneath the floor. Fixing devices for the floor are not included since different floor materials require different types of fixing devices. For advice on suitable fixing devices for your floor, contact your local specialised dealer.

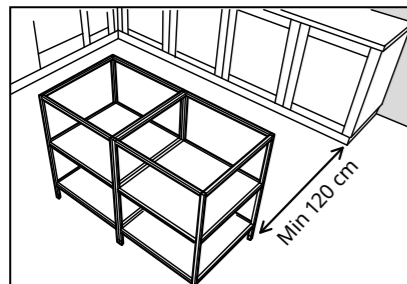

Start by deciding where the island will be positioned. We recommend that you leave 120 cm between the island and the other kitchen units to ensure a good workflow in the kitchen.

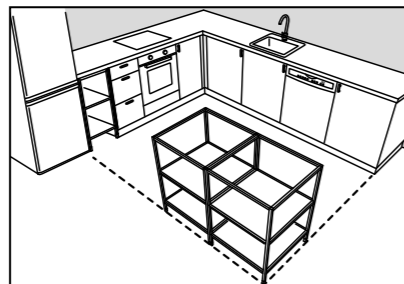

For a straight island that aligns with the rest of the kitchen, use reference points in the room (for example base cabinets).

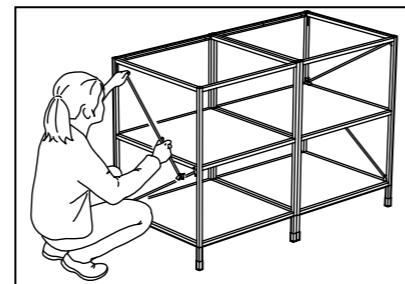

Make sure you assemble the cabinet stabilisers onto the frames according to the assembly instruction that comes with the assembly kit for kitchen island.

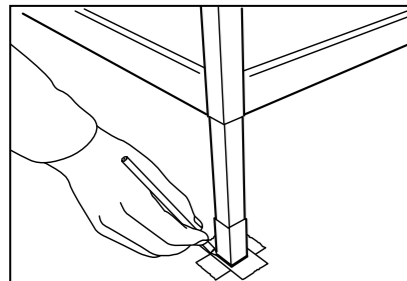

Once you have positioned the frames, add some temporary tape underneath each leg and mark the perimeter of each leg sleeve as accurately, since this will be the final location of your kitchen island.

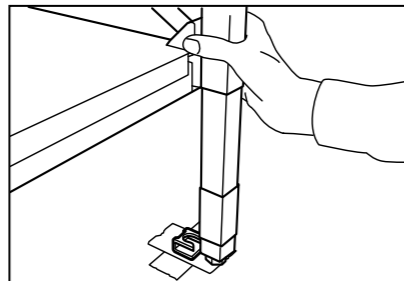

Use the anchoring metal brackets included in the assembly kit for kitchen island to secure the kitchen island to the floor.

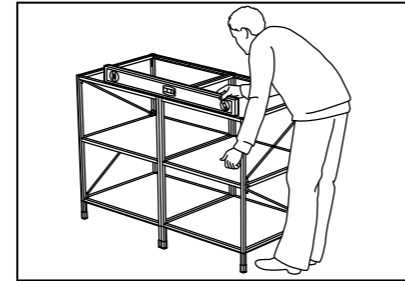

After you have slid the legs into the anchoring fittings, connect all frames, using the connectors included with the frames. We recommend that you use a large spirit level to check that the cabinets are level in all directions. To make minor adjustments, adjust the height of the legs.

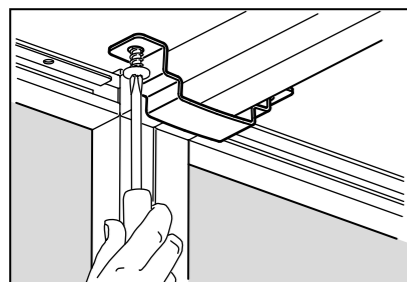

Measure and resize the worktop if needed. As you place it on top of the island, make sure you have an equal overhang all around. Then, attach it using the brackets provided with your base unit.

# You're done! Congratulations on your new kitchen!

Time to step back and admire your new kitchen. With a little care and maintenance, your IKEA kitchen will look great for many years to come.

## Caring for your cabinets

Clean the doors, cabinet interiors and wood surfaces with a soft, damp cloth. Only use cleaning products intended for these materials. Do not use products that contain ammonia, alcohol, bleach or abrasives. Rinse with clean water, then dry with a clean, dry cloth. Make sure to clean up spills quickly.

## Keep your sink sparkling

After each use, wipe the sink clean with a cloth or sponge dampened in water or a non-abrasive detergent, if necessary. Rinse the bowl with water and then wipe the sink with a dry cloth. Avoid scouring powder, steel wool, or hard objects which can scratch the stainless steel surface. The damp surface can be discoloured if substances containing iron, such as steel wool, nails or gravel, are allowed to remain on it. Discolouration is caused by the foreign material.

## Long-lasting worktops

Keep your worktop in top condition by cleaning spills quickly with water and a mild detergent. Be sure to keep them as dry as possible after use. For wood and solid wood worktops use STOCKARYD wood treatment oil. The oil protects the wood from marks, stains and cracks, and prevents water from penetrating the surface.

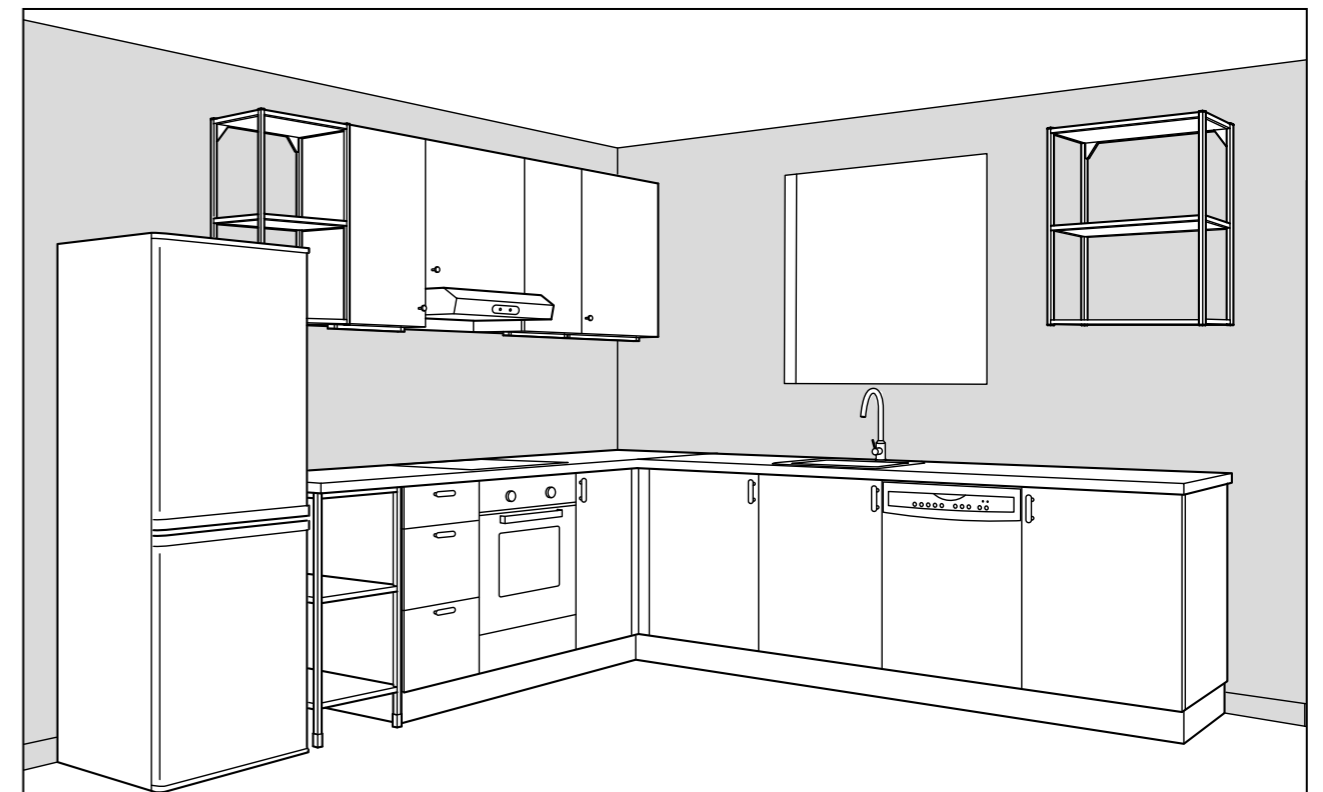



# Services

---

Our broad service offer gives you the freedom to decide how much you want to do yourself and how much you want us to do for you.



## Ways of Payment

We offer flexible ways of payment to start furnishing your home today, without having to pay immediately.

**For more information visit**  
[www.IKEA.gr](http://www.IKEA.gr)

---



## Measuring

If you want to be sure that your room drawing is as accurate as possible, we measure the room and check everything, from the placement of windows, doors, and power sockets to the material and condition of the walls.

**For more information visit**  
[www.IKEA.gr](http://www.IKEA.gr)

---



## Planning

Get help with the planning of your new kitchen, by booking an appointment with one of our experts at IKEA. You bring the measurements and drawing or a picture of the area – we help you with inspiration and functional solutions for everything, from the placement of cabinets and appliances, desks and storage to lighting, sinks and wash-basins.

**For more information visit**  
[www.IKEA.gr](http://www.IKEA.gr)

---



## Delivery

Whether you're shopping in store or online, and no matter how big the purchase, we'll do the heavy lifting and bring it to your home or business. We deliver on a day and at a time that suits you.

**For more information visit**  
[www.IKEA.gr](http://www.IKEA.gr)

---



## Removal

When you buy a kitchen with delivery from us we're happy to take care of your old one. Whatever can't be used will be recycled responsibly.

**For more information visit**  
[www.IKEA.gr](http://www.IKEA.gr)

---



## Assembly

Sometimes it's nice to have someone else put your furniture together. We're happy to do it for you. Getting us to put it together can be a real time-saver.

**For more information visit**  
[www.IKEA.gr](http://www.IKEA.gr)

---



## Kitchen installation

If you want to make things smooth and easy for you – we'll install your new kitchen and coordinate the job from start to finish. We handle all those time-consuming jobs like fitting sinks, taps and worktops. And you can rest assured that the installation of gas/electric appliances is done properly. We also take the packaging with us when your kitchen is in place.

**For more information visit**  
[www.IKEA.gr](http://www.IKEA.gr)

---